

## \_ANT-SYNC Antenna



Figure - ANT-SYNC

ANT-SYNC is an active GPS/GLONASS antenna designed to filter and amplify RF signals received from global navigation satellite systems (GNSS) and feed them to a GNSS receiver at InfiLINK XG, InfiLINK XG 1000 families models. GNSS receiver recovers timing and positioning data which is used to provide timing reference for TDD synchronization as well as to make device location information available for EMS and NMS systems via SNMP protocol.

As an active antenna, it protects the receiver from interference coming from co-located 3G/LTE BTSS, which would make GNSS signals irrecoverable otherwise. It requires DC power for normal operation, which is fed via the RF port, so it can only be used with compatible GNSS receivers such as those built into InfiLINK XG, InfiLINK XG 1000 families models.

TDD synchronization allows multiple co-located units to operate co-channel or use adjacent channels thus achieving frequency re-use and eliminate self interference. Because of GNSS-based timing reference, both intra- and inter-site synchronization can be supported.

Parameter	Description
Antenna type	<ul style="list-style-type: none"><li>GLONASS/GPS, active, external</li></ul>
Frequency bands	<ul style="list-style-type: none"><li>GLONASS - 1602 MGz (L1)</li><li>GPS - 1575 MGz (L1)</li></ul>
Input DC range	<ul style="list-style-type: none"><li>+5 VDC</li></ul>
RF connector	<ul style="list-style-type: none"><li>N-type (Female)</li></ul>
Ingress protection	<ul style="list-style-type: none"><li>IP66, IP67</li></ul>
Size and weight	<ul style="list-style-type: none"><li>180x170x72 mm, 0.36 kg</li></ul>

<b>Operating temperature range</b>	<ul style="list-style-type: none"> <li>• -40°C...+60°C</li> </ul>
<b>Relative humidity</b>	<ul style="list-style-type: none"> <li>• Up to 100%</li> </ul>

**Table - Technical specifications of ANT-SYNC**

## Installation

Installation must be performed by a professional installer only.

ANT-SYNC can be installed on a pole, using components kit from the delivery package. The recommended guidelines are given below:

- Screw the threaded studs (1) to the unit case.
- Tighten the device and the bracer (2) on the pole and fix them by the threaded studs (1) using the nuts and washers (3) as shown at the picture.

Typical pole diameter is 30 to 85 mm.

The N-type connector (4) is used to connect to the outdoor unit using the cable assembly from the delivery package.

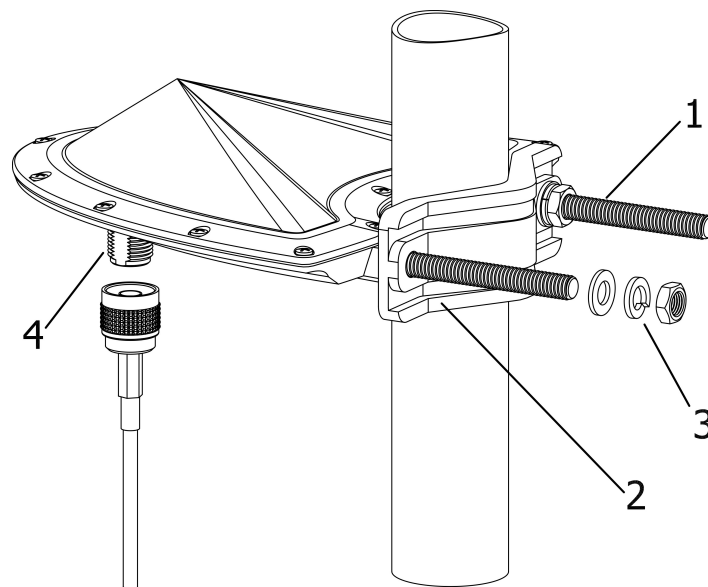

**1 – Threaded studs, 2 – Bracer, 3 – Nut and washer, 4 – N-type connector**  
**Figure - ANT-SYNC Mounting**